

# C-818HD FOR C-104 OR C-108 TRACK

## INSTRUCTION SHEET

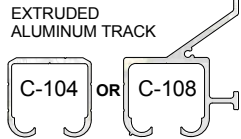

### PARTS LIST

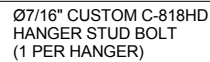
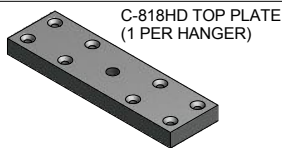
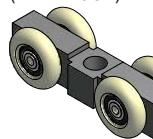

7/16" HEX JAM NUT  
(1 PER HANGER)

7/16" LOCK WASHER  
(1 PER HANGER)

#10 X 2" FLATHEAD  
SCREWS (8 PER HANGER)

### SPECIFICATIONS:

-LOAD CAPACITY:  
450 LBS PER DOOR.

-HEAVY DUTY 7/16" DIAMETER BOLT

-HEAVY-DUTY PRECISION BALL BEARING WHEELS WITH NYLON TIRE.

-FOR HEAVY-DUTY BY-PASSING, BI-PARTING, POCKET, AND SURFACE MOUNT/BARN STYLE APPLICATIONS.

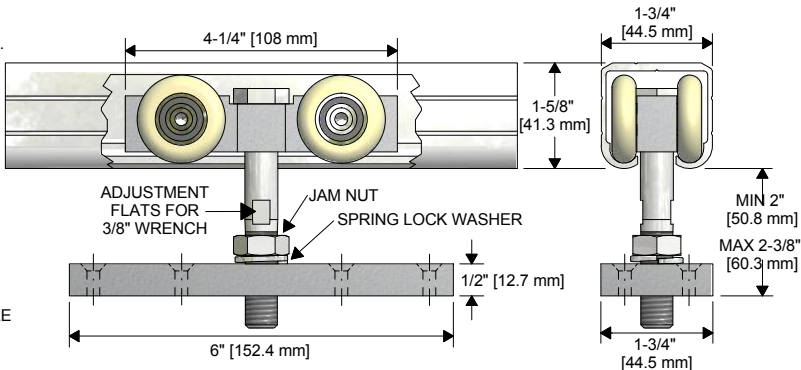

### STEP 1

DETERMINE DOOR SIZE/HEADER HEIGHT BASED ON DIMENSIONS SHOWN IN DETAIL VIEWS AND CLEARANCE REQUIRED BELOW DOOR. NOTE: DUE TO STUD LENGTH, THE C-818HD HANGER IS USUALLY INSTALLED FULLY ASSEMBLED ON THE DOOR. THE COMPLETE ASSEMBLY IS THEN "LOADED" ONTO THE TRACK FROM ONE END. FOR BI-PARTING APPLICATIONS IT IS RECOMMENDED THAT THE TRACK BE INSTALLED IN TWO PIECES. MOUNT ONE PIECE TO THE HEADER, LOAD BOTH DOORS INTO TRACK, AND THEN INSTALL SECOND LENGTH OF TRACK.

### STEP 2

A) LOCATE CLEARANCE HOLE FOR HANGER STUD 5-1/2" FROM EACH EDGE OF DOOR. DRILL WITH 1/2" BIT AT LEAST 1" DEEP. IF USING KNC CAS-2 DOOR STOP, LOCATE CLEARANCE HOLE 6-1/2" FROM EDGE OF DOOR.  
B) CENTER TOP PLATE OVER HOLE, MARK SCREW HOLE LOCATIONS AND PRE-DRILL WITH 1/8" BIT AT LEAST 1-1/2" DEEP.

### STEP 3

MOUNT TOP PLATE ON DOOR AND SECURE WITH #10 X 2" FLATHEAD SCREWS (8 PER TOP PLATE). INSERT C-818HD STUD BOLT INTO HANGER AND PLACE A 7/16" HEX NUT WITH LOCK WASHER ON BOLT. INSTALL THIS ASSEMBLY ONTO THE TOP PLATE ON THE DOOR.

### STEP 4

PREPARE DOOR FOR INSTALLATION OF OPTIONAL PRODUCTS IF PURCHASED SUCH AS GUIDE CHANNELS, CUP PULLS, DOOR LOCKS, ETC. INDIVIDUAL INSTRUCTIONS ARE PROVIDED WITH THE RESPECTIVE PRODUCT.

### STEP 5

LOAD DOOR(S) ONTO TRACK AND SECURE TO HEADER.

### STEP 6

ADJUST DOOR HEIGHT AND PLUMB VIA ADJUSTMENT FLATS ON BOLT WITH 3/8" WRENCH. LOCK ADJUSTMENT BY TIGHTENING HEX NUT AGAINST LOCK WASHER & TOP PLATE.

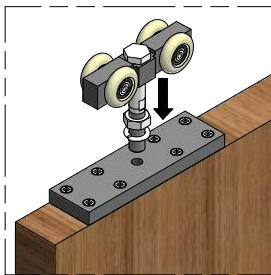
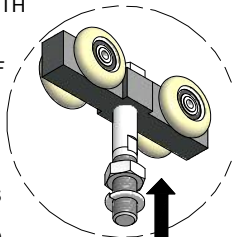
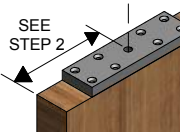

# C-818HD FOR C-104 OR C-108 TRACK

## INSTRUCTION SHEET



### PARTS LIST

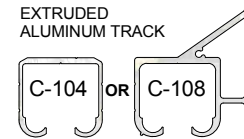
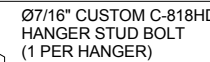
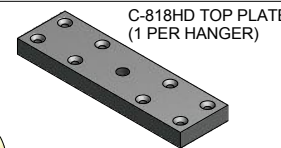
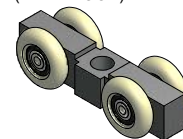

7/16" HEX JAM NUT  
(1 PER HANGER)

7/16" LOCK WASHER  
(1 PER HANGER)

#10 X 2" FLATHEAD  
SCREWS (8 PER HANGER)

### SPECIFICATIONS:

-LOAD CAPACITY:  
450 LBS PER DOOR.

-HEAVY DUTY 7/16" DIAMETER BOLT

-HEAVY-DUTY PRECISION BALL BEARING WHEELS WITH NYLON TIRE.

-FOR HEAVY-DUTY BY-PASSING, BI-PARTING, POCKET, AND SURFACE MOUNT/BARN STYLE APPLICATIONS.

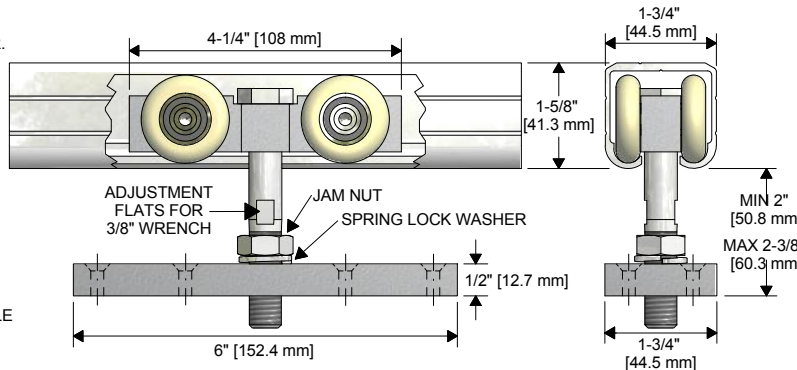

### STEP 1

DETERMINE DOOR SIZE/HEADER HEIGHT BASED ON DIMENSIONS SHOWN IN DETAIL VIEWS AND CLEARANCE REQUIRED BELOW DOOR. NOTE: DUE TO STUD LENGTH, THE C-818HD HANGER IS USUALLY INSTALLED FULLY ASSEMBLED ON THE DOOR. THE COMPLETE ASSEMBLY IS THEN "LOADED" ONTO THE TRACK FROM ONE END. FOR BI-PARTING APPLICATIONS IT IS RECOMMENDED THAT THE TRACK BE INSTALLED IN TWO PIECES. MOUNT ONE PIECE TO THE HEADER, LOAD BOTH DOORS INTO TRACK, AND THEN INSTALL SECOND LENGTH OF TRACK.

### STEP 2

A) LOCATE CLEARANCE HOLE FOR HANGER STUD 5-1/2" FROM EACH EDGE OF DOOR. DRILL WITH 1/2" BIT AT LEAST 1" DEEP. IF USING KNC CAS-2 DOOR STOP, LOCATE CLEARANCE HOLE 6-1/2" FROM EDGE OF DOOR.  
B) CENTER TOP PLATE OVER HOLE, MARK SCREW HOLE LOCATIONS AND PRE-DRILL WITH 1/8" BIT AT LEAST 1-1/2" DEEP.

### STEP 3

MOUNT TOP PLATE ON DOOR AND SECURE WITH #10 X 2" FLATHEAD SCREWS (8 PER TOP PLATE). INSERT C-818HD STUD BOLT INTO HANGER AND PLACE A 7/16" HEX NUT WITH LOCK WASHER ON BOLT. INSTALL THIS ASSEMBLY ONTO THE TOP PLATE ON THE DOOR.

### STEP 4

PREPARE DOOR FOR INSTALLATION OF OPTIONAL PRODUCTS IF PURCHASED SUCH AS GUIDE CHANNELS, CUP PULLS, DOOR LOCKS, ETC. INDIVIDUAL INSTRUCTIONS ARE PROVIDED WITH THE RESPECTIVE PRODUCT.

### STEP 5

LOAD DOOR(S) ONTO TRACK AND SECURE TO HEADER.

### STEP 6

ADJUST DOOR HEIGHT AND PLUMB VIA ADJUSTMENT FLATS ON BOLT WITH 3/8" WRENCH. LOCK ADJUSTMENT BY TIGHTENING HEX NUT AGAINST LOCK WASHER & TOP PLATE.

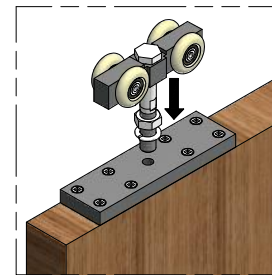
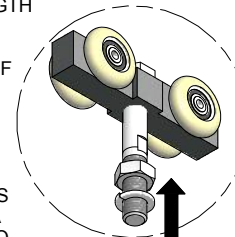
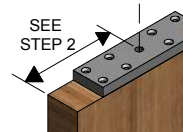

**K.N. CROWDER MFG. INC.**  
1220 BURLOAK DRIVE  
BURLINGTON, ONTARIO, CANADA, L7L 6B3  
TELEPHONE: 905-315-9788 - FAX: 905-315-8090  
TOLL FREE PHONE: 1-866-999-1KNC (1562)  
TOLL FREE FAX: 1-800-567-0123

WEBSITE: [www.kncrowder.com](http://www.kncrowder.com) --- E-MAIL: [customerservice@kncrowder.com](mailto:customerservice@kncrowder.com)

**K.N. CROWDER INC.**  
210 EIGHTH STREET SOUTH  
LEWISTON, NEW YORK, U.S.A. 14092  
TELEPHONE: 1-716-754-8247  
TOLL FREE FAX: 1-800-567-0123



**K.N. CROWDER MFG. INC.**  
1220 BURLOAK DRIVE  
BURLINGTON, ONTARIO, CANADA, L7L 6B3  
TELEPHONE: 905-315-9788 - FAX: 905-315-8090  
TOLL FREE PHONE: 1-866-999-1KNC (1562)  
TOLL FREE FAX: 1-800-567-0123

WEBSITE: [www.kncrowder.com](http://www.kncrowder.com) --- E-MAIL: [customerservice@kncrowder.com](mailto:customerservice@kncrowder.com)

**K.N. CROWDER INC.**  
210 EIGHTH STREET SOUTH  
LEWISTON, NEW YORK, U.S.A. 14092  
TELEPHONE: 1-716-754-8247  
TOLL FREE FAX: 1-800-567-0123